

00139180

## LIFTOFF hinge

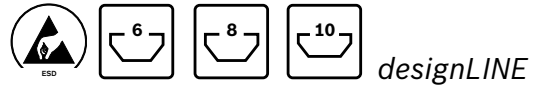

designLINE

- ▶ Compact, removable hinge for doors which open to the right or left
- ▶ designLINE version with special silver paint (RAL 9006) for an attractive, high-quality design
- ▶ Centering lugs as an assembly aid and anti-torsion element

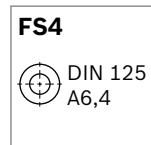
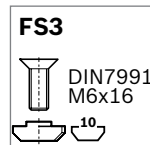
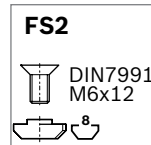
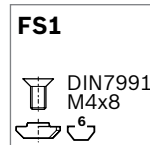
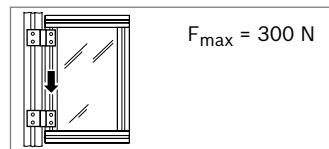
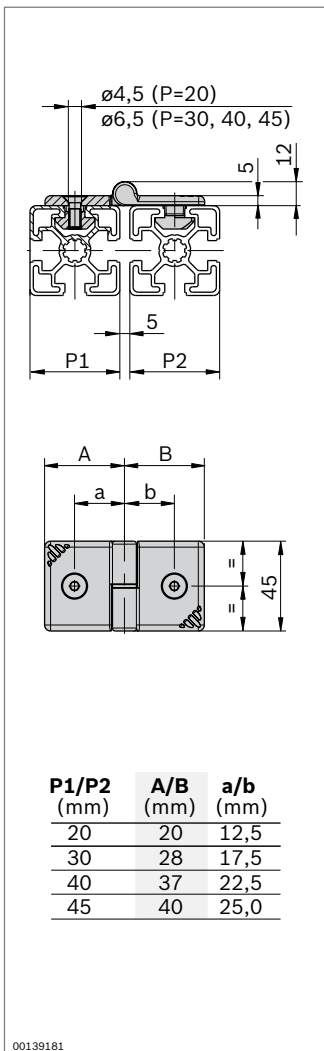

P1/P2 (mm)	A/B (mm)	a/b (mm)
20	20	12,5
30	28	17,5
40	37	22,5
45	40	25,0

00139181

LIFTOFF hinge	P1 (mm)	P2 (mm)		No.	FS
right	20	20	2	<b>3 842 543 334</b>	2xFS1, FS4
	20	30	2	<b>3 842 543 333</b>	FS1, FS2, FS4
	30	30	2	<b>3 842 543 332</b>	2xFS2, FS4
	30	40	2	<b>3 842 543 331</b>	FS2, FS3, FS4
	30	45	2	<b>3 842 543 330</b>	FS2, FS3, FS4
	40	40	2	<b>3 842 543 329</b>	2xFS3, FS4
	45	45	2	<b>3 842 543 328</b>	2xFS3, FS4
left	20	20	2	<b>3 842 543 327</b>	2xFS1, FS4
	20	30	2	<b>3 842 543 326</b>	FS1, FS2, FS4
	30	30	2	<b>3 842 543 325</b>	2xFS2, FS4
	30	40	2	<b>3 842 543 324</b>	FS2, FS3, FS4
	30	45	2	<b>3 842 543 323</b>	FS2, FS3, FS4
	40	40	2	<b>3 842 543 322</b>	2xFS3, FS4
	45	45	2	<b>3 842 543 321</b>	2xFS3, FS4

Material: Hinge: diecast aluminum, painted  
 Fastening material: steel; galvanized  
 Grooved pin: steel; galvanized  
 Washer: PA

Scope of delivery: incl. fastening material (FS)